

James M^c. Nary

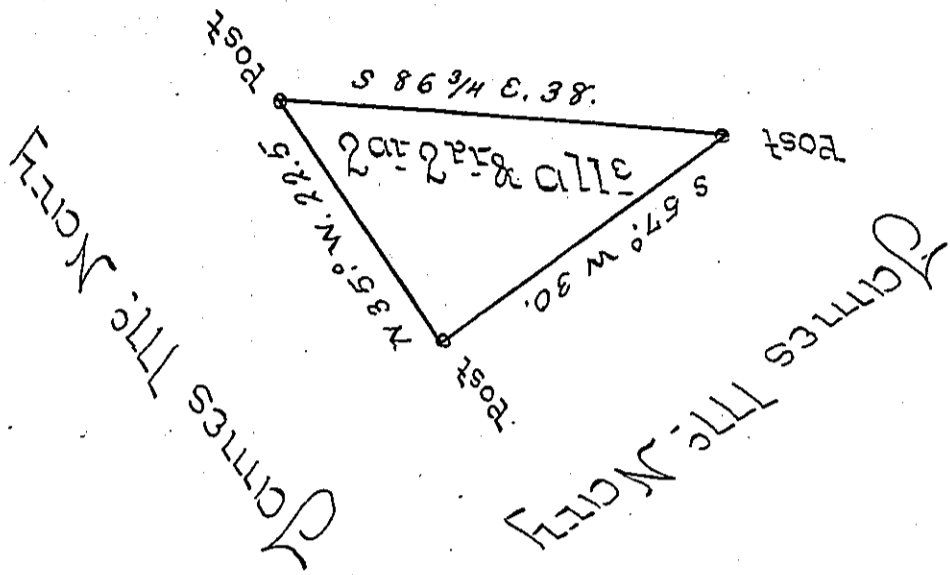

The above is a draught of a tract of land called Aberdeen situate on the waters of Mingo Creek in Nottingham township Washington county containing two acres and two perches with the usual allowance. Surveyed in pursuance of a warrant granted James M^c. Nary dated 7th of ~~November~~ March 1817 and executed October 25th 1817 -

James Reed D.S.

Rich^d. M. Beech Esq^r S.G.
of the Commonwealth of Pa

P.S. The above mentioned land is improved -
There is no adverse claim that I know of -
J. Reed.

IN TESTIMONY that the above is a copy of the original remaining on file in the Department of Internal Affairs of Pennsylvania, made conformably to an Act of Assembly approved the 16th day of February, 1833, I have hereunto set my Hand and caused the Seal of said Department to be affixed at Harrisburg, this nineteenth day of February 1906.

Loac A. Brown
Secretary of Internal Affairs.